

Please read the instructions carefully. If any part of these instructions are not clear, or not understood, please call Nelson Rigg or consult a qualified or experienced mechanic / technician. Below diagrams show typical installation, your vehicle may be different so please use diagrams as a guide. Make sure your vehicle is clean and free from dirt, road grime etc. where the this product mounts. It is the riders responsibility to make sure the product is mounted and secure before each use. Loading the bag may result in a change of position, always check for proper mounting position after loading and before each and every ride.

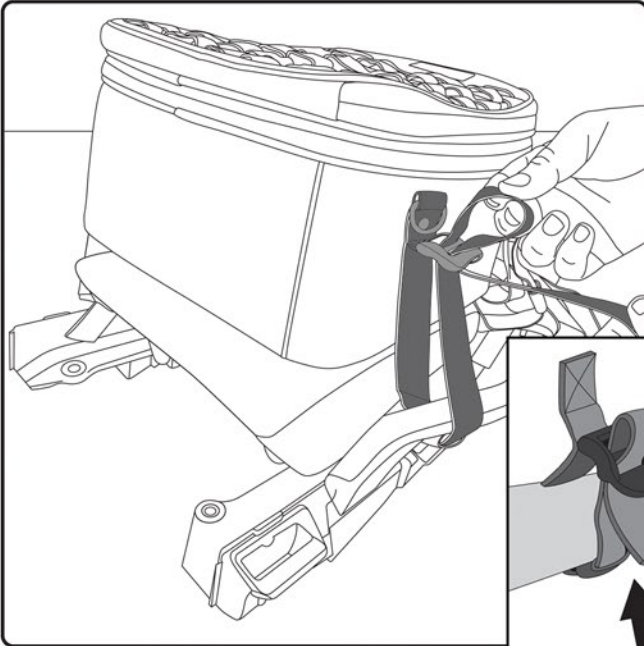

- 1) Position tail bag on seat or rack on the motorcycle. Make sure bag is centered and free from all moving and hot parts. Always store heavier items in the bottom of the bag for better weight distribution and balance.
- 2) Pass the webbing straps around the rack tubing, grab handles or other secure mounting location on the bike.
- 3) Feed the webbing through the tensionlock buckle as shown in the diagram.

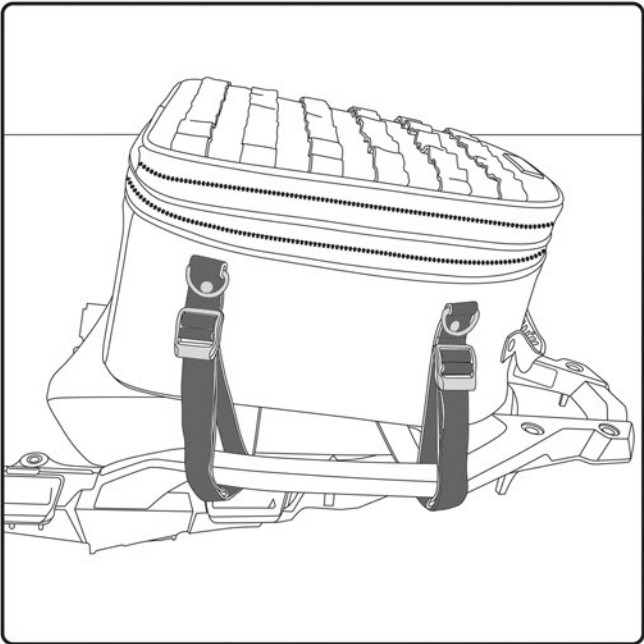
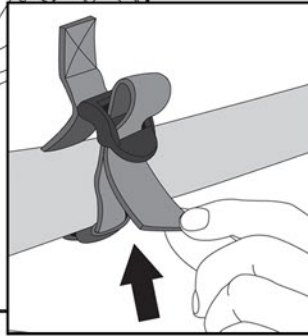

- 1) Once all straps have been routed correctly, start to pull tight each strap one at a time making sure the bag does not shift and stays centered.
- 2) Any extra strap can be folded and tucked inside the provided elastic strap loops.
- 3) Make sure bag is secure and has little movement before operating vehicle.

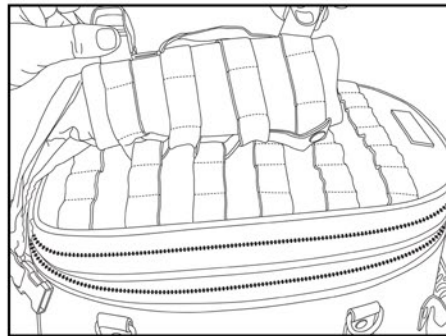

The MOLLE webbing is for our optional fuel bottle holder RG-1060 and other MOLLE accessories.

Warning:

Read the installation instructions and make yourself familiar with the process of installing the Nelson-Rigg® product(s) on your bike. It is your responsibility to mount the product correctly and securely as outlined in these instructions. Nelson-Rigg® products are intended for use at USA street legal speeds as posted by the individual States. Nelson-Rigg® luggage must not be overloaded. Max carrying capacity is 10 lbs per bag or the maximum load suggested by the manufacturer of the vehicle, whichever is less. Failure to adhere to these warnings may result in, but not be limited to: the luggage becoming detached, the product becoming tangled in moving parts of the vehicle, unstable vehicle dynamics, reduction in the ability to control the vehicle. The result(s) could lead to serious injury. Always ride safely, adhering to the local highway regulations. Always wear a helmet and protective apparel.



3518 W. Lake Center Dr Ste A, Santa Ana, CA 92704
Tel (714)850-1811
e-mail: info@nelsonrigg.com www.nelsonrigg.com